

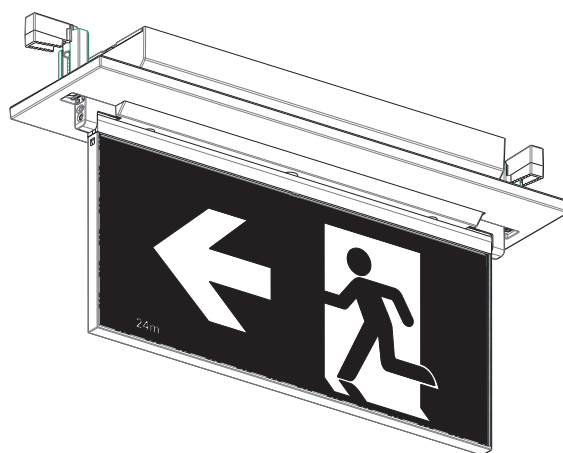

Surface-Mounted



Recessed

### Specifications:

Supply Voltage	Input Power
230-240V a.c. 50Hz	3W

\*4 decals are provided - Running Man, Running Man Left, Running Man Right, Opaque white

### Note:

This sign is configured for maintained operation only.

### How to replace decal/s before installing body to bracket

**Step 1:** Use 3mm slot screwdriver to detach original decal. Depress metal clips at each end to release the decal cover assembly.

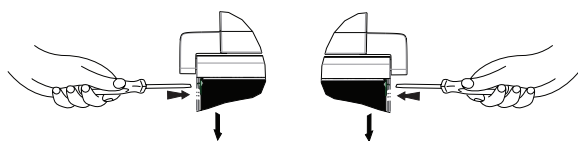

**Step 2:** Clean the lens before inserting decal.

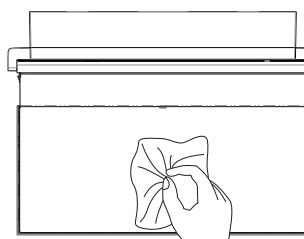

**Step 3:** Once decal is changed, slide decal assembly over lens to click into position.

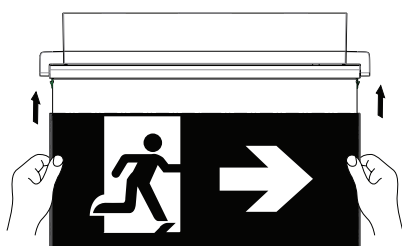

**Step 4:** Decal assembly will lock into place.

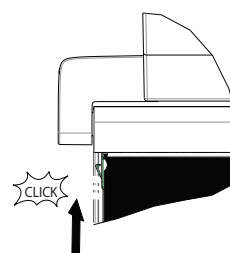

**NOTE:** To make decal replacement easier, remove body from mounting plate.  
Press test switch for local test when installation is complete.  
Ensure correct orientation. Terminal Block will be at opposite end to LED & Test Switch.

## MIRAGE PLUS

### Ceiling or Wall Mounted

- Step 1:** Fit the required decal/s as described on page 1.  
**Step 2:** Secure the mounting plate to the wall or ceiling.

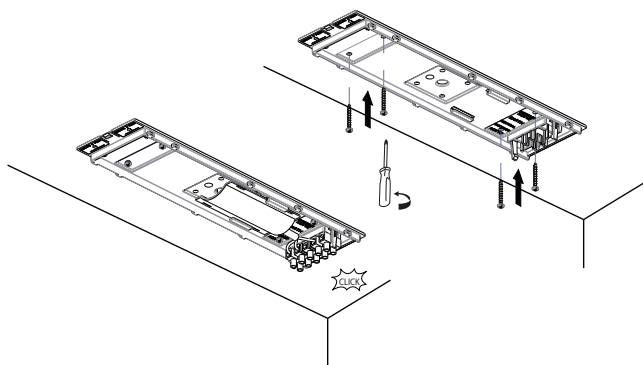

- Step 3a:** Terminate Unswitched Active, Neutral and Earth supply cables to terminal block.  
**Step 3b:** Terminate DALI cables to terminal block (DALI models only)

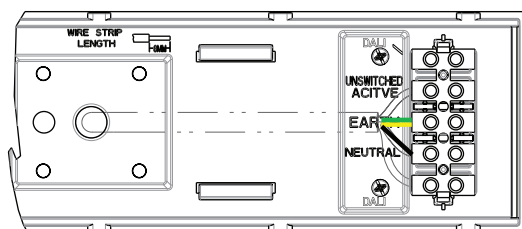

- Step 3c:** Fit the protective cover to the cableway.

- Step 4a:** Fit the body to the mounting plate by raising it to ceiling level.

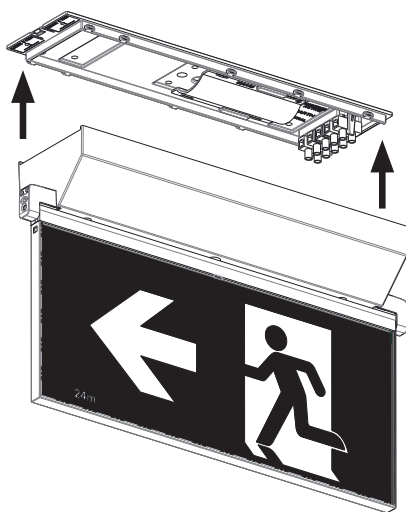

- Step 4b:** Locate and slide cover horizontally towards the terminal block until it connects securely.

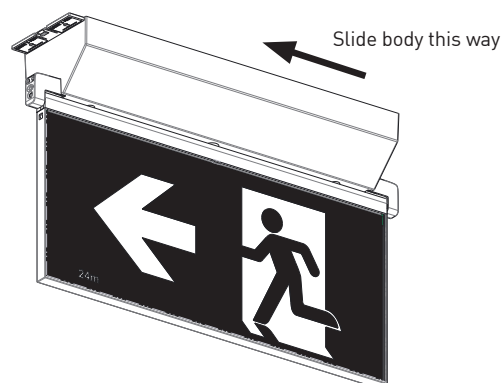

- Step 5:** Apply power to the sign and confirm that:
- Indicator LED is flashing.
  - Running Man is illuminated.

### Removal

To remove the body from mounting plate, push tab up and slide out the body as shown.

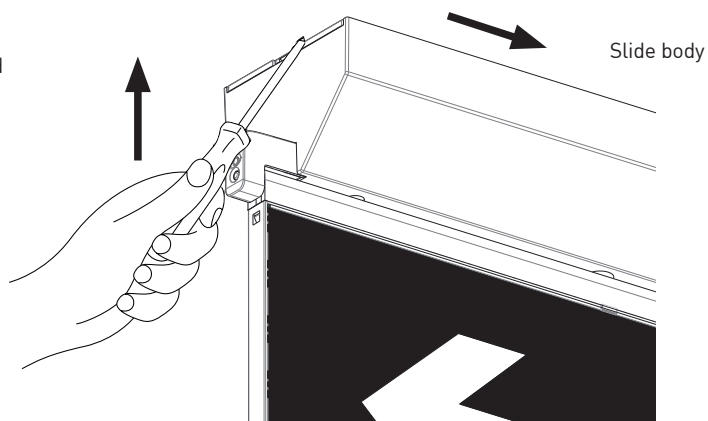

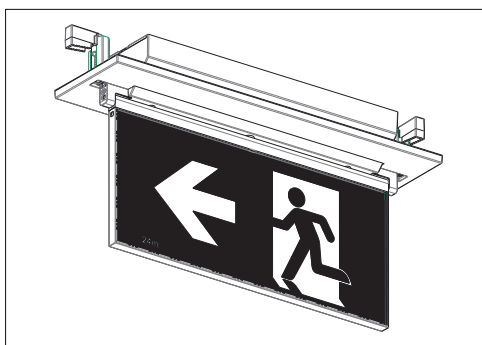
**Recessed Edgelight**

- Step 1:** Fit the required decal/s as described previously.
- Step 2:** Ensure Unswitched Active is available adjacent to where the sign will be installed.
- Step 3:** Determine a compliant location before cutting.
- Step 4:** Use the cut-out template provided to cut an exact opening.

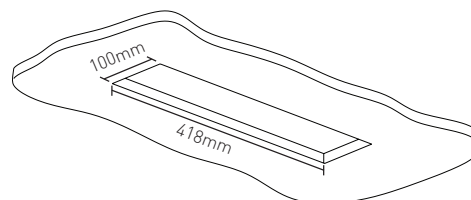

**Step 5:** Terminate the Unswitched Active, Neutral and Earth supply cables to the terminal block on the plate provided or fit an Australian approved flex and 3-pin plug as required, enlarging the selected entry hole to suit a cable gland. Terminate DALI cables to the terminal block (DALI models only).

**Step 6:** Fit the protective cover to the cableway and secure the slide-on cover to the Exit body as described previously.

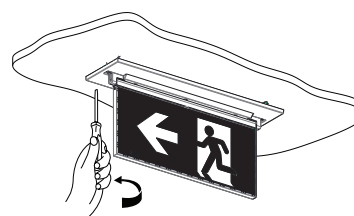
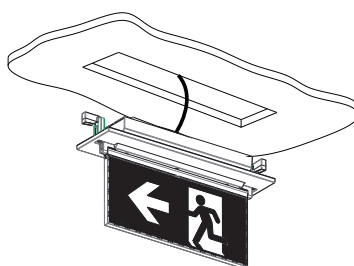
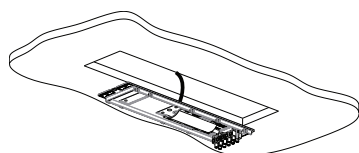

**Step 7:** Note the orientation of the plate so that the LED and Test Switch will be most visible and accessible. Plug in the fixture before fixing the luminaire and recessing plate securely to the ceiling using the swing clamps provided. Don't over-tighten the screws or damage to the ceiling tile may occur.

